



SUNSHINE CLASSIC AWNING

Technical Information List

V 030818



General View

Retractable & Ready to Mount, with Chosen Fabric
This product comes standard as: manual operated with a winder/crank handle.

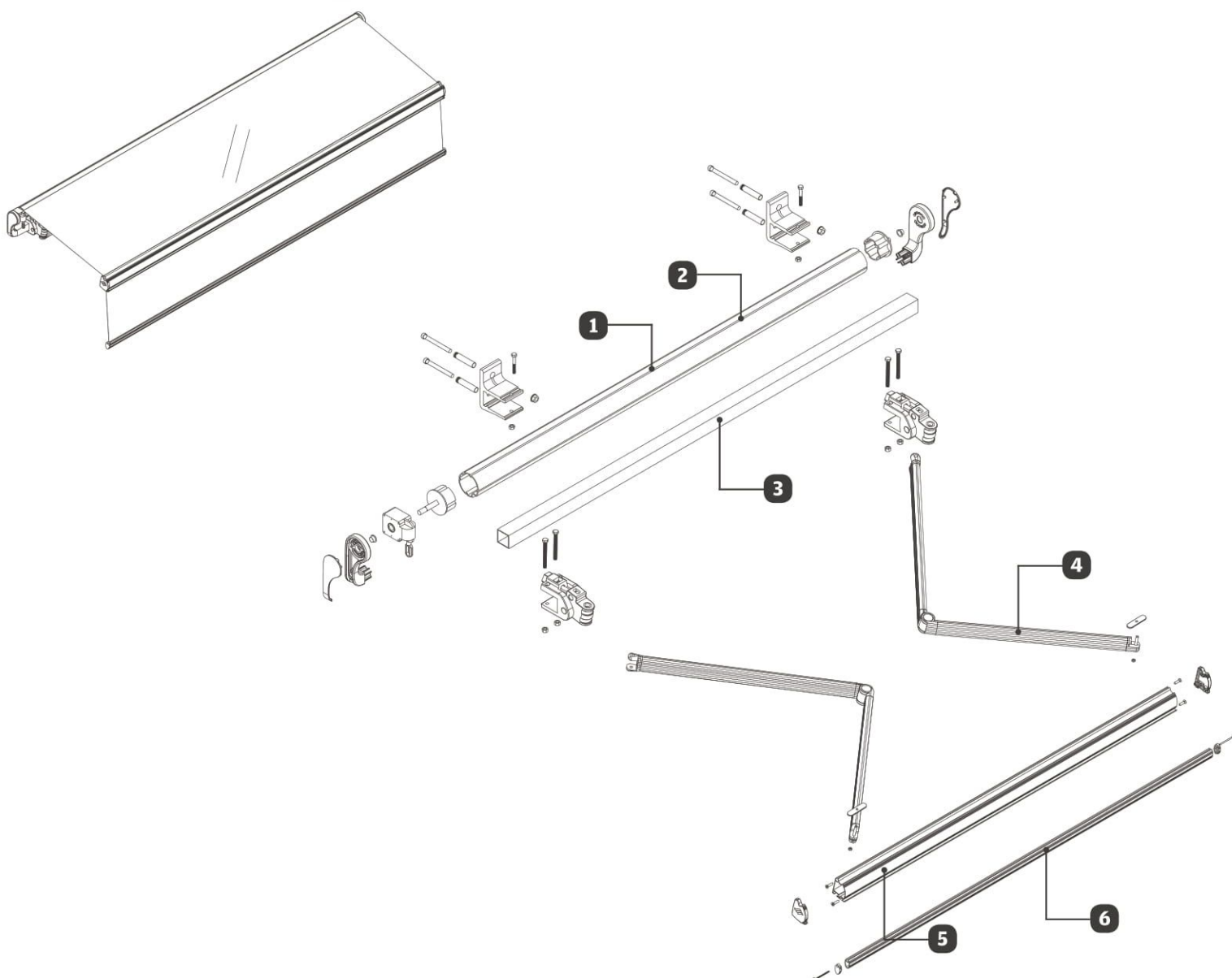

1 Roller Tube Ø70

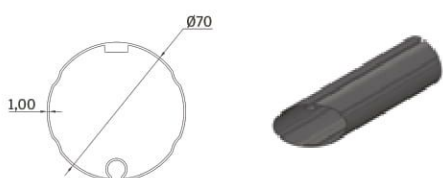

2 Roller Tube Ø78

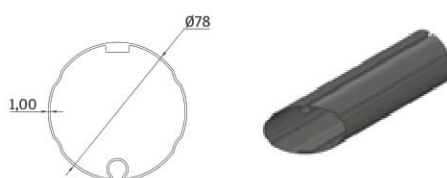

3 Iron Profile 40x40

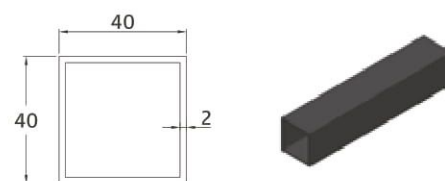

4 Arm Profile

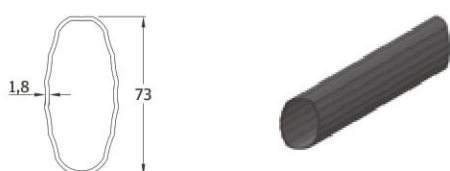

5 Front Profile

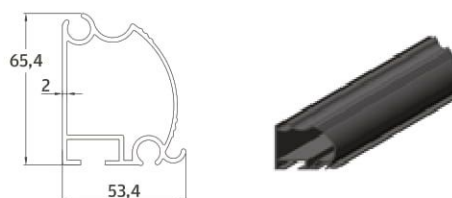

6 Valance Weight Bar

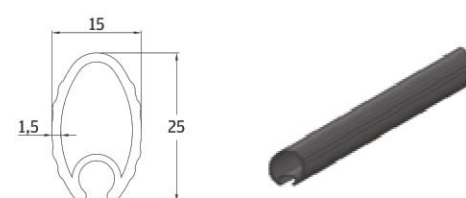

* All dimensions shown above are in millimeters.

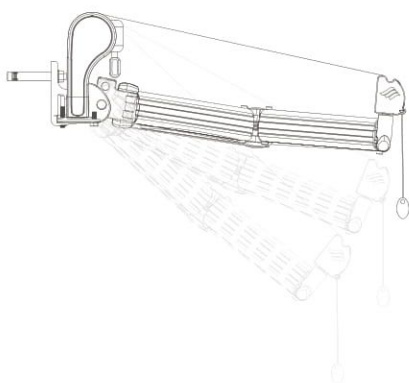
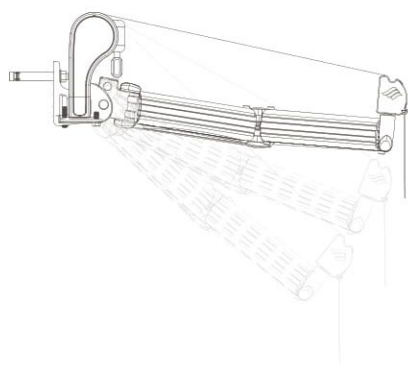

Wall Installation Bracket

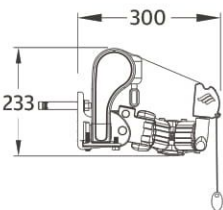

Ceiling Installation Bracket

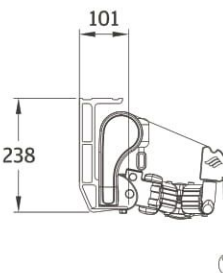

Minimum Degree	5°	French Fringe Standard	250 mm
Maximum Degree	45°	French Fringe Maximum	500 mm



Minimum Degree	5°	Victoria Fringe Standard	250 mm
Maximum Degree	45°	Victoria Fringe Maximum	500 mm

Motor with Indoor Wall Switch



Motor with Remote Control



Motor with Indoor Wall Switch & Gear Redactor



Motor with Remote Control & Gear Redactor



Somfy Wind Sensor



Somfy Wind and Sun Sensor



Somfy Rain Sensor



Rising Infrared Heater



Fabric Colour Swatch



Aluminium Powder Coating



Iron Parts



Selection of Optional Items & Accessories

● Arm Support with Inclination Adjustment System



● Aerosol Touch-up Spray Paint



● Silicone



● Packaging with Hardened Kraft, Round Cylinder



● Packaging with Wooden Crate



Manufacturer of **Shading Systems**
for Outdoor Spaces

