

# FALCATE **TECTONA**

Technical Information List

V 030818

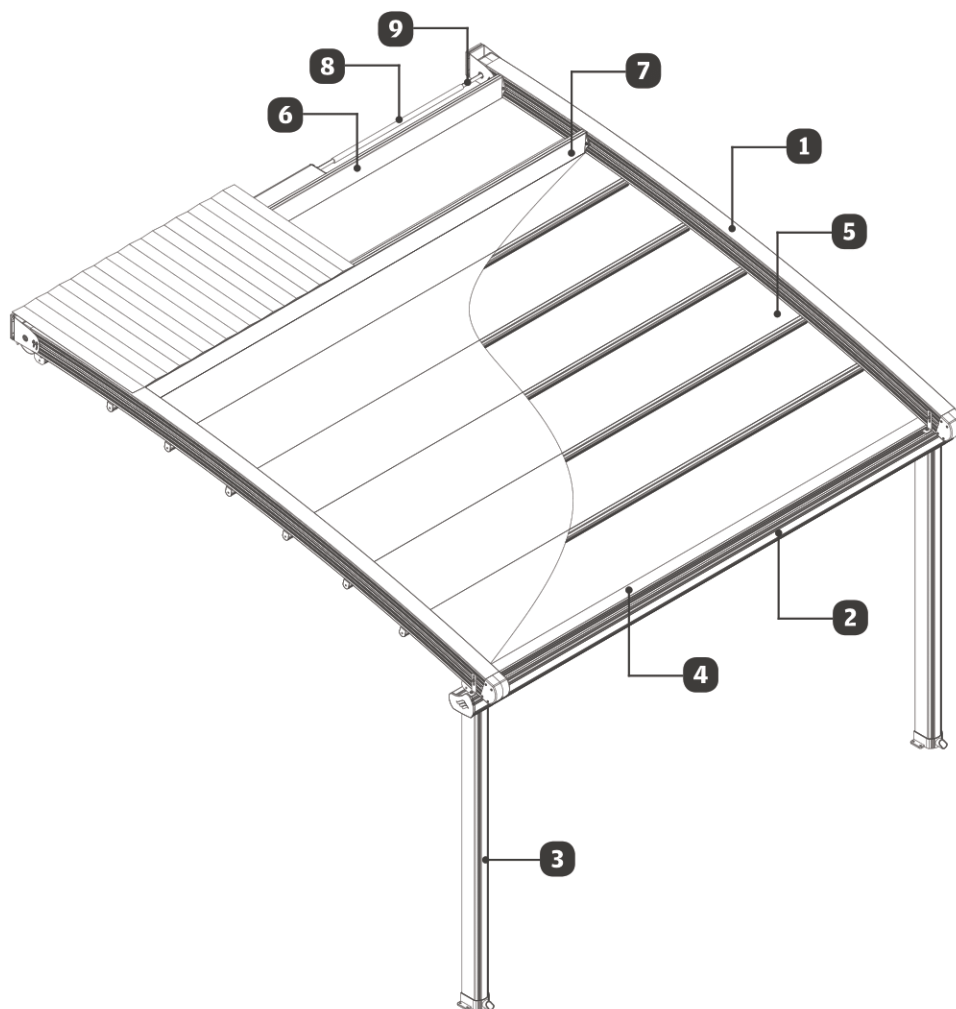



**1** Rafter Profile

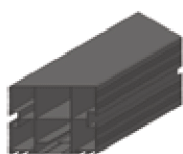
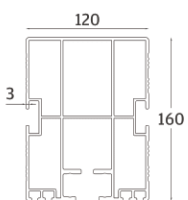

**2** Gutter Profile

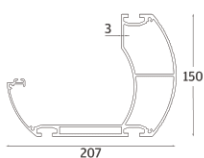

**3** Carrier Post Profile

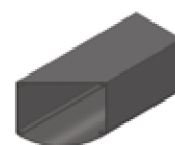
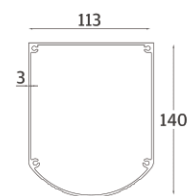

**4** Fabric Profile | Master

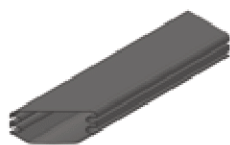
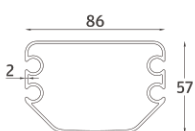

**5** Fabric Profile | Carrier

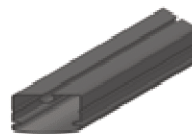
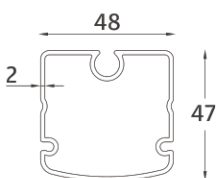

**6** Motor Box Profile

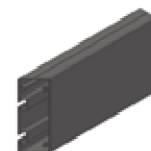
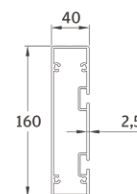

**7** Roof Sash Profile

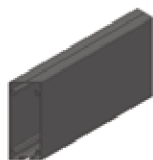
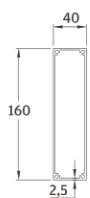

**8** Motor Shaft Pipe Profile | Thick



**9** Motor Shaft Pipe Profile | Thin



\* All dimensions shown above are in millimeters.

### Single Module

Max. Width as 4000  
Standard Carrier Post Profile height as 2500



### Double Module

Max. Width as 8000  
Standard Carrier Post Profile height as 2500

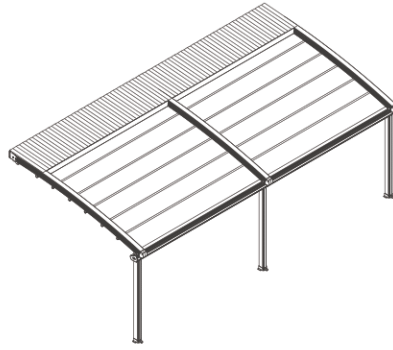

### Triple Module

Max. Width as 12000  
Standard Carrier Post Profile height as 2500

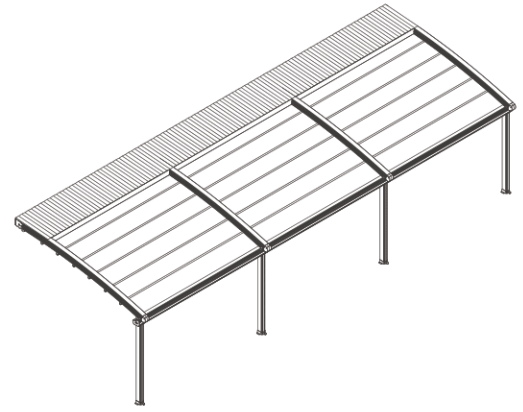

### Technical Side View

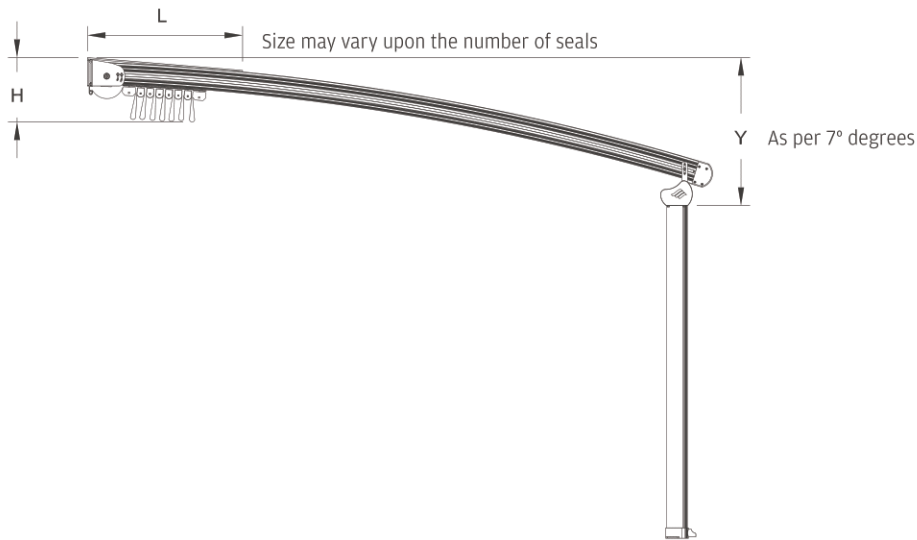

∇ Projection ^	Fabric Fall Height (H)	Hood Cover (L)	7° Degree Rule Fall Height (Y)	Fabric Profile Carrier
3000	562	710	920	7 pcs
3500	571	780	998	8 pcs
4000	580	850	1073	9 pcs
4500	589	920	1143	10 pcs
5000	598	990	1206	11 pcs
5500	607	1130	1264	12 pcs
6000	616	1200	1314	13 pcs
6500	625	1270	1364	14 pcs
7000	634	1340	1405	15 pcs
7500	643	1410	1441	16 pcs
8000	652	1480	1472	17 pcs
8500	661	1550	1497	18 pcs
9000	670	1620	1517	19 pcs
9500	679	1690	1531	20 pcs
10000	688	1760	1540	21 pcs

\* Distances between fabric profiles had been calculated and measured as 50 cm and it may. Vary upon the measurement of each project therefore you are kindly requested to Contact your key account manager in order to avoid any misunderstanding other wise Rising shading systems will not be responsible for any mistakes that may occur.

\* All dimensions shown above are in milimeters.

Fabric Colour Swatch

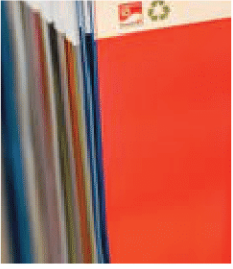

Somfy Wind Sensor



Somfy Wind and Sun Sensor



Somfy Rain Sensor



Rising Infrared Heater



Aluminium Powder Coating



Aerosol Touch-up Spray Paint



Bi-Metal Holesaw



Silicone



Packaging with Wooden Crate



Ballcony Glass & Glazing Systems



Manufacturer of **Shading Systems**  
for Outdoor Spaces



S T R I N G   L I G H T S  
—  
O U T D O O R