

R3 SUBULATE **TECTONA**

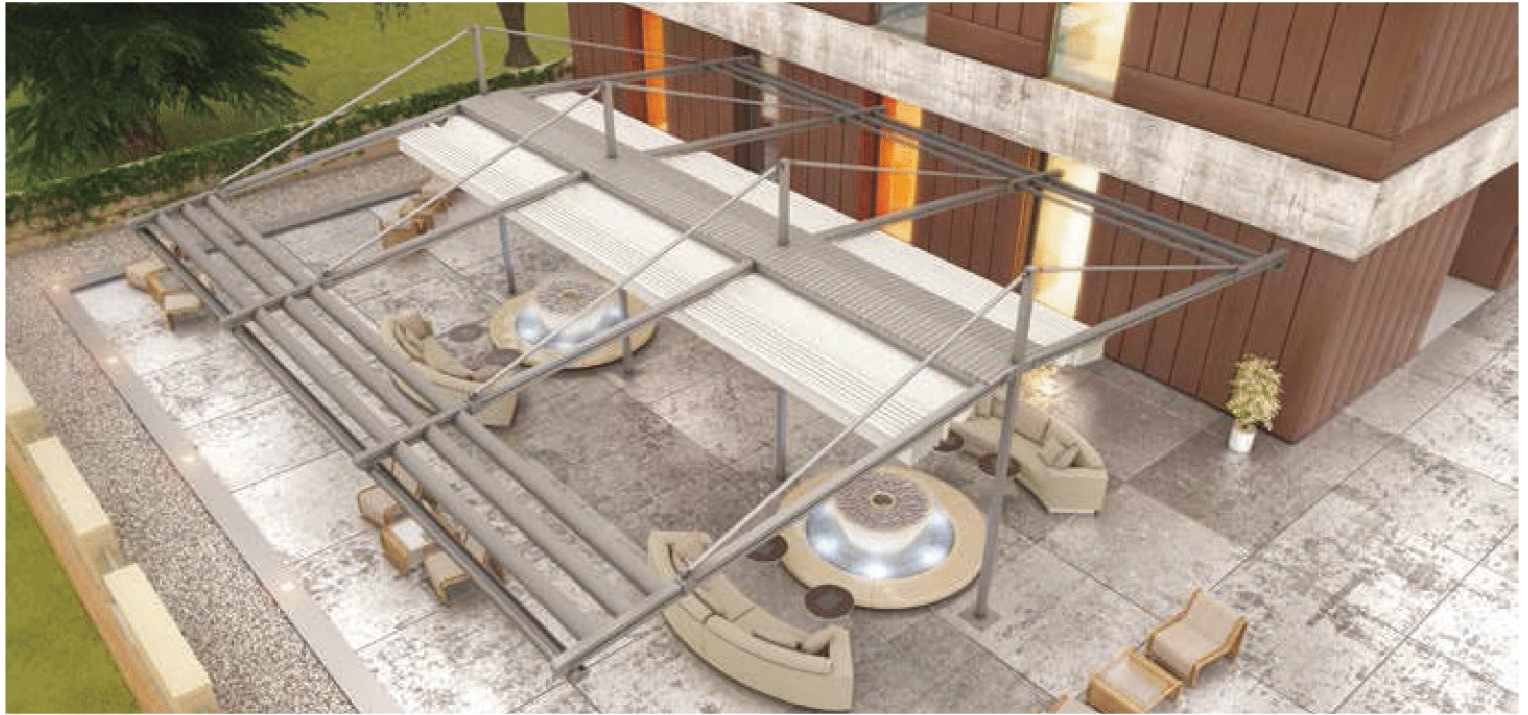

Technical Information List

V 240318



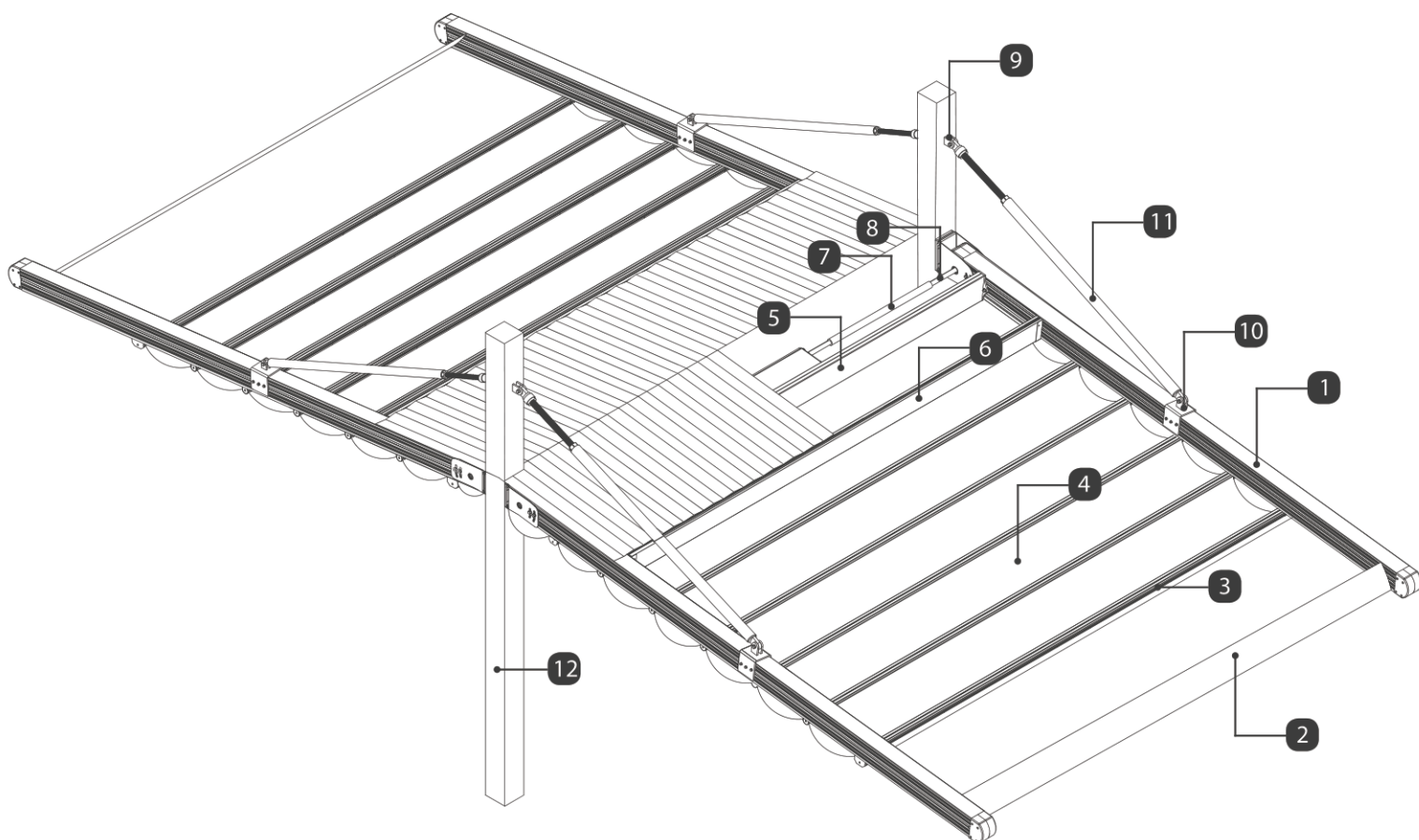

1 Rafter Profile

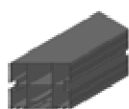
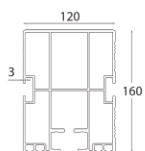

2 Aerofoil Louvre Profile

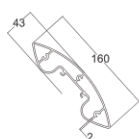

3 Fabric Profile | Master

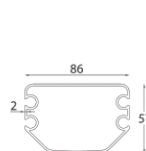

4 Fabric Profile | Carrier

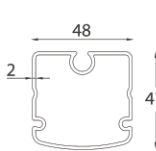

5 Motor Box Profile

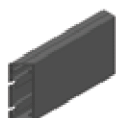
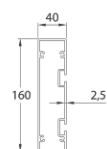

6 Roof Sash Profile

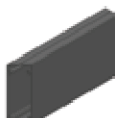
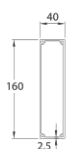

7 Motor Shaft Pipe Profile | Thick

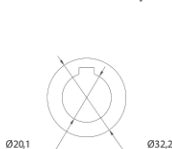

8 Motor Shaft Pipe Profile | Thin



9 Wall Hanging Bracket

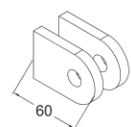

10 Rafter Hanging Bracket

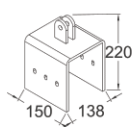

11 Hanging Tube



12 Iron Profile 100x100



Single Module

Max. Rafter Profile width as 4000
Max. Carrier Post Profile width as 5000



Double Module

Max. Rafter Profile width as 8000
Max. Carrier Post Profile width as 5000

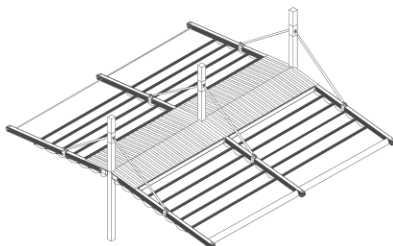

Triple Module

Max. Rafter Profile width as 12000
Max. Carrier Post Profile width as 2000

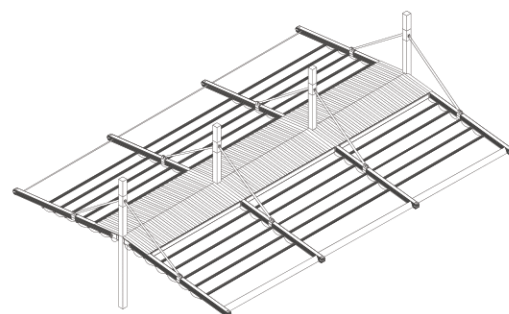

Technical Side View

Size may vary upon the number of seals

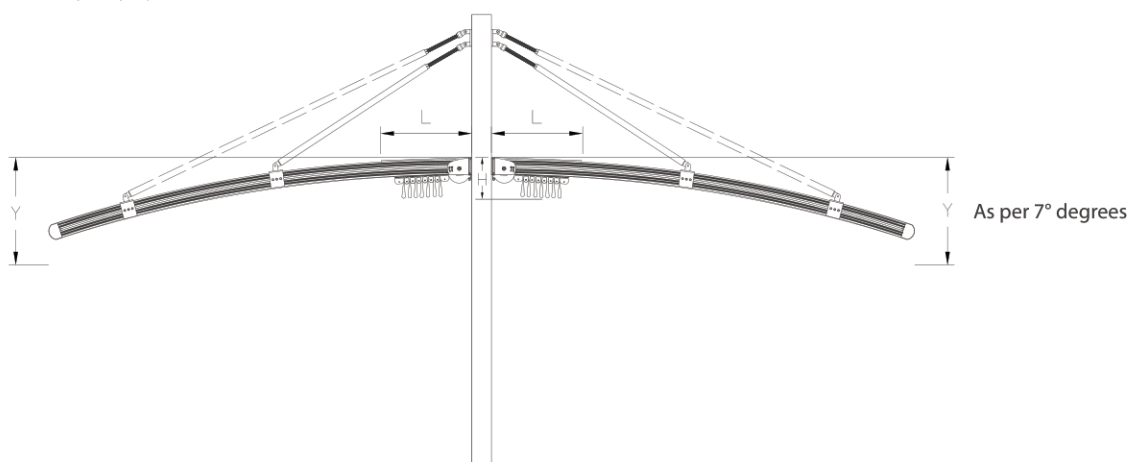

∇ Projection ^	Fabric Fall Height (H)	Hood Cover (L)	7° Degree Rule Fall Height (Y)	Fabric Profile Carrier
3000	542	710	680	7 pcs
4000	554	850	803	9 pcs
5000	566	990	925	11 pcs

* Distances between fabric profiles had been calculated and measured as 50 cm and it may. Vary upon the measurement of each project therefore you are kindly requested to Contact your key account manager in order to avoid any misunderstanding other wise Rising shading systems will not be responsible for any mistakes that may occur.

Possible Module Combinations

Fabric Colour Swatch

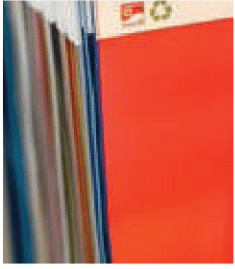

Somfy Wind Sensor



Somfy Wind and Sun Sensor



Somfy Rain Sensor



Rising Infrared Heater



Aluminium Powder Coating



Aerosol Touch-up Spray Paint



Bi-Metal Holesaw



Silicone



Packaging with Wooden Crate



Ballcony Glass & Glazing Systems



Manufacturer of **Shading Systems**
for Outdoor Spaces

Address : Unit C,
Canalside North Business Park,
John Gilbert Way, Trafford Park,
Manchester, M17 1UP
United Kingdom

Phone : +44 (0) 845 400 4677

E-mail : contact@gossoutdoor.co.uk

R3 SUBULATE **QUERCUS MINIMA**

Technical Information List

V 240318

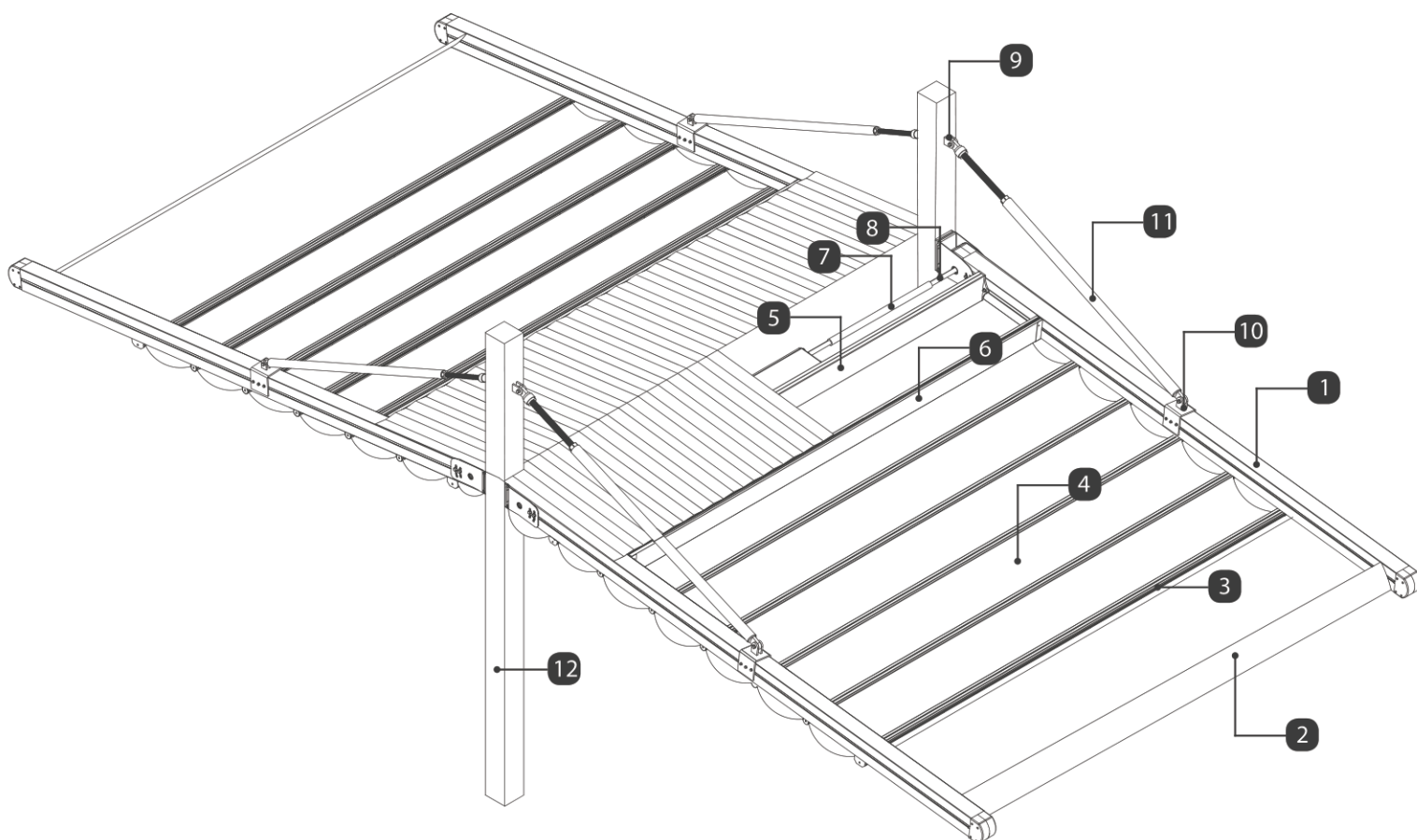

1 Rafter Profile

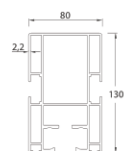

2 Aerofoil Louvre Profile

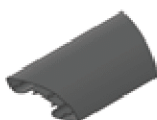
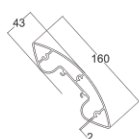

3 Fabric Profile | Master

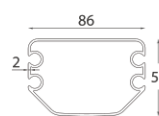

4 Fabric Profile | Carrier

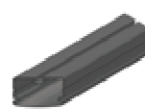
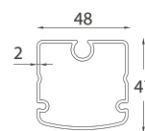

5 Motor Box Profile

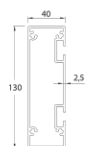

6 Roof Sash Profile

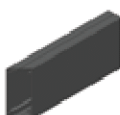
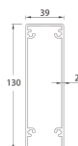

7 Motor Shaft Pipe Profile | Thick



8 Motor Shaft Pipe Profile | Thin



9 Wall Hanging Bracket

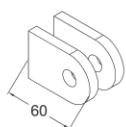

10 Rafter Hanging Bracket

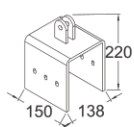

11 Hanging Tube



12 Iron Profile 100x100

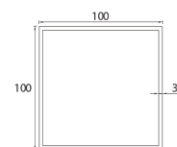

Single Module

Max. Rafter Profile width as 4000
Max. Carrier Post Profile width as 5000



Double Module

Max. Rafter Profile width as 8000
Max. Carrier Post Profile width as 5000

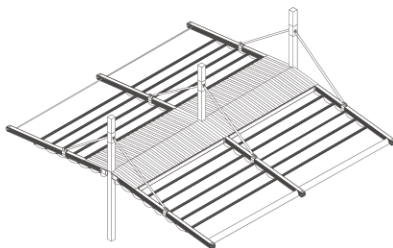

Triple Module

Max. Rafter Profile width as 12000
Max. Carrier Post Profile width as 2000

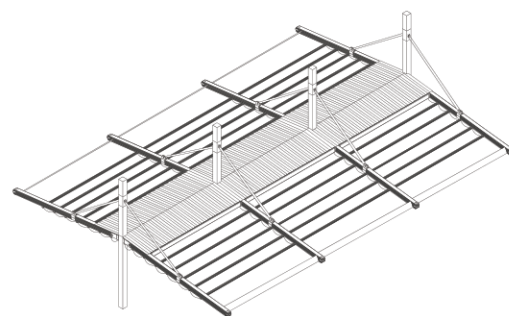

Technical Side View

Size may vary upon the number of seals

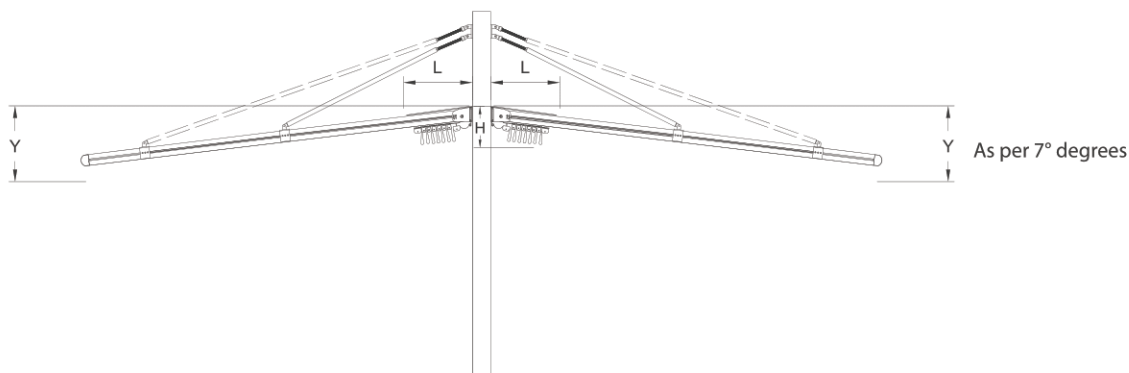

∇ Projection ^	Fabric Fall Height (H)	Hood Cover (L)	7° Degree Rule Fall Height (Y)	Fabric Profile Carrier
3000	519	710	650	7 pcs
4000	537	850	770	9 pcs
5000	555	990	890	11pcs

* Distances between fabric profiles had been calculated and measured as 50 cm and it may. Vary upon the measurement of each project therefore you are kindly requested to Contact your key account manager in order to avoid any misunderstanding other wise Rising shading systems will not be responsible for any mistakes that may occur.

Possible Module Combinations

Fabric Colour Swatch

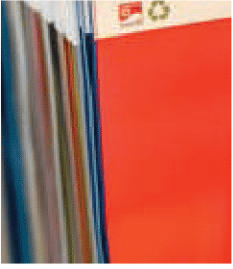

Somfy Wind Sensor



Somfy Wind and Sun Sensor



Somfy Rain Sensor



Rising Infrared Heater



Aluminium Powder Coating



Aerosol Touch-up Spray Paint



Bi-Metal Holesaw



Silicone



Packaging with Wooden Crate



Ballcony Glass & Glazing Systems



Manufacturer of **Shading Systems**
for Outdoor Spaces

Address : Unit C,
Canalside North Business Park,
John Gilbert Way, Trafford Park,
Manchester, M17 1UP
United Kingdom

Phone : +44 (0) 845 400 4677

E-mail : contact@gossoutdoor.co.uk

R3 SUBULATE

ULMUS 

Technical Information List

V 240318

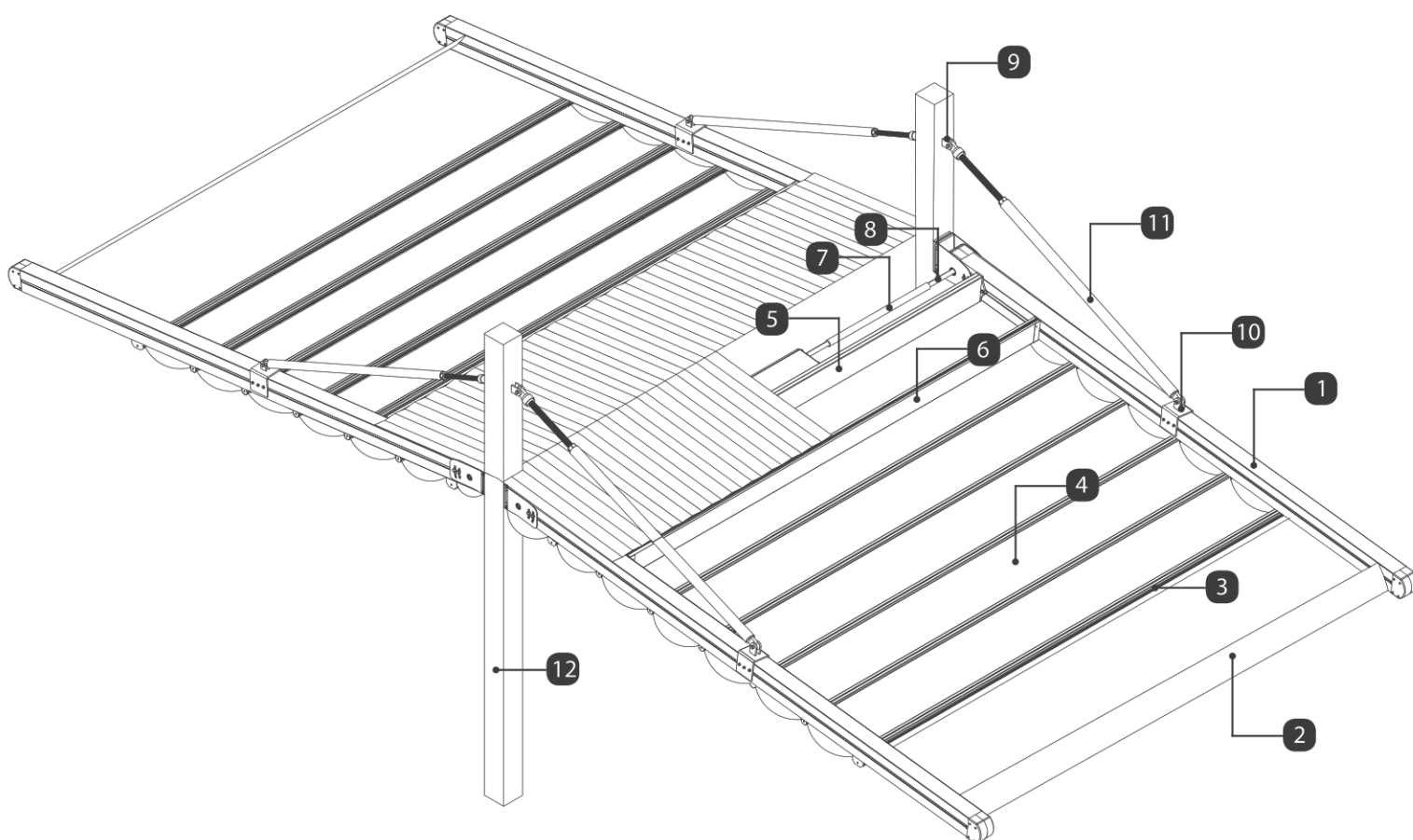

1 Rafter Profile

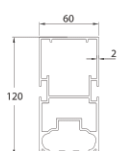

2 Aerofoil Louvre Profile

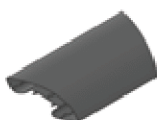
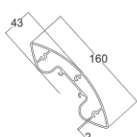

3 Fabric Profile | Master

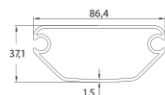

4 Fabric Profile | Carrier

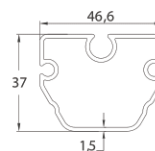

5 Motor Box Profile

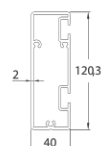

6 Roof Sash Profile

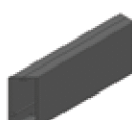

7 Motor Shaft Pipe Profile | Thick



8 Motor Shaft Pipe Profile | Thin



9 Wall Hanging Bracket

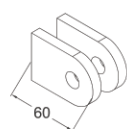

10 Rafter Hanging Bracket

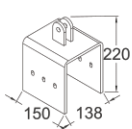

11 Hanging Tube



12 Iron Profile 100x100

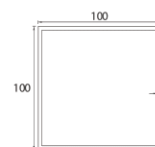

Single Module

Max. Rafter Profile width as 4000
Max. Carrier Post Profile width as 5000



Double Module

Max. Rafter Profile width as 8000
Max. Carrier Post Profile width as 5000

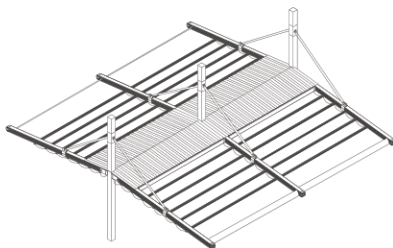

Triple Module

Max. Rafter Profile width as 12000
Max. Carrier Post Profile width as 2000

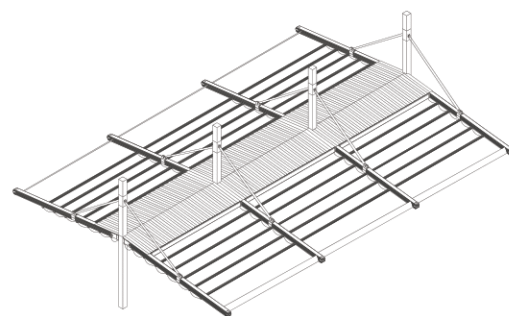

Technical Side View

Size may vary upon the number of seals

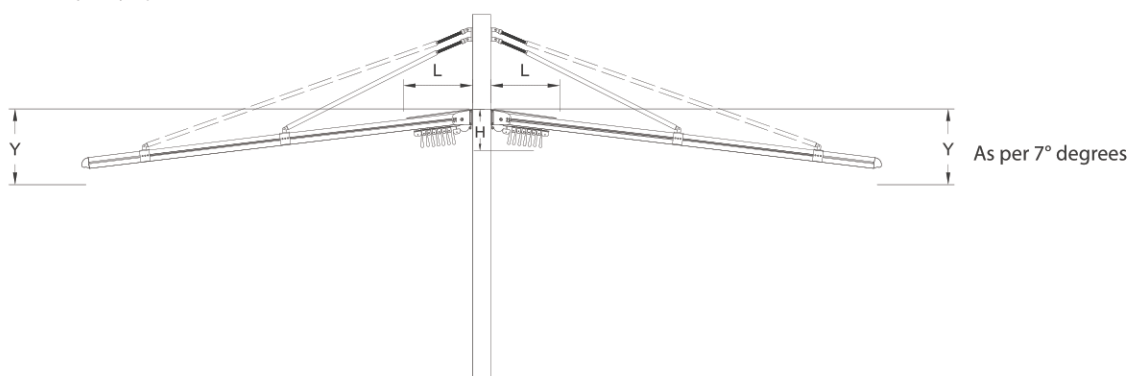

∇ Projection ^	Fabric Fall Height (H)	Hood Cover (L)	7° Degree Rule Fall Height (Y)	Fabric Profile Carrier
3000	506	640	640	7 pcs
4000	520	760	760	9 pcs
5000	534	880	880	11pcs

* Distances between fabric profiles had been calculated and measured as 50 cm and it may. Vary upon the measurement of each project therefore you are kindly requested to Contact your key account manager in order to avoid any misunderstanding other wise Rising shading systems will not be responsible for any mistakes that may occur.

Possible Module Combinations

Fabric Colour Swatch

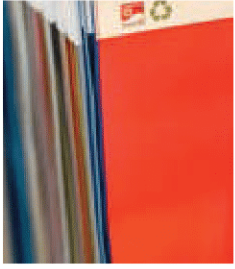

Somfy Wind Sensor



Somfy Wind and Sun Sensor



Somfy Rain Sensor



Rising Infrared Heater



Aluminium Powder Coating



Aerosol Touch-up Spray Paint



Bi-Metal Holesaw



Silicone



Packaging with Wooden Crate



Ballcony Glass & Glazing Systems



Manufacturer of **Shading Systems**
for Outdoor Spaces

Address : Unit C,
Canalside North Business Park,
John Gilbert Way, Trafford Park,
Manchester, M17 1UP
United Kingdom

Phone : +44 (0) 800 400 4549

E-mail : contact@gossoutdoor.co.uk